

# GX

SUPERYACHTS

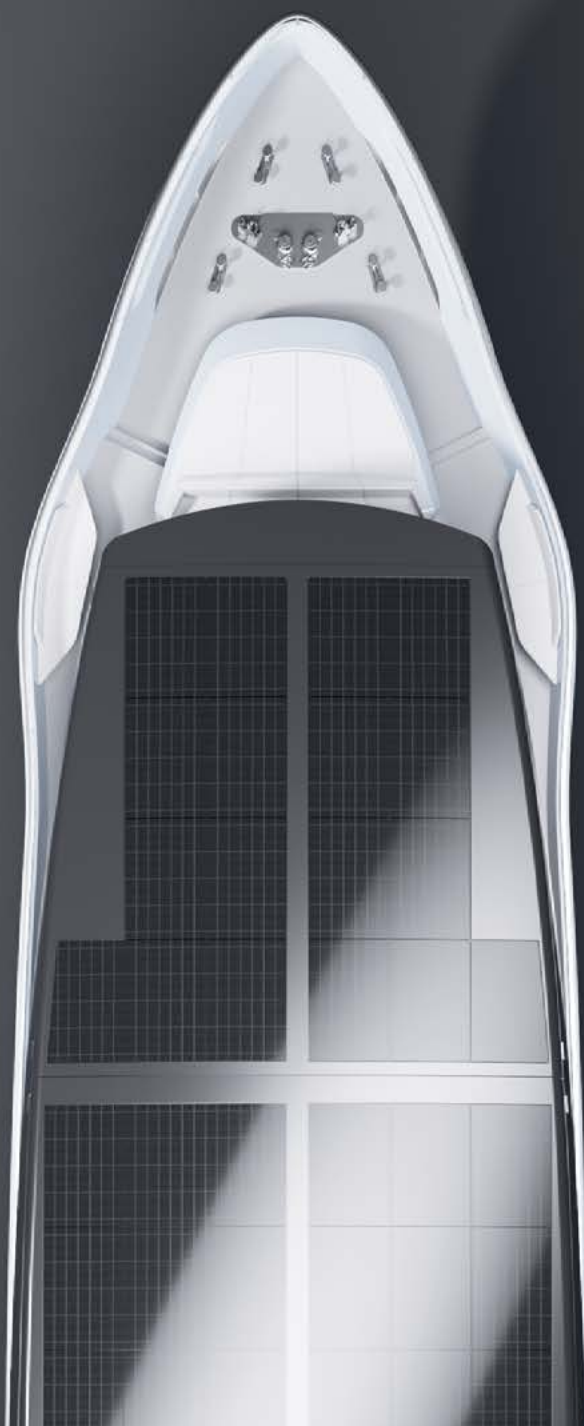

„With 16 years of experience in hybrid propulsion for pleasure yachting, coupled with insights from over 1,000 yachts delivered, we are excited to bring our expertise to our new superyacht lineup, embodying responsible yachting and true comfort.“

*Vladimir Zinchenko - CEO & Founder*

Known from:

**Forbes**

**BOAT**  
International

SUPERYACHT  
TIMES

Robb Report

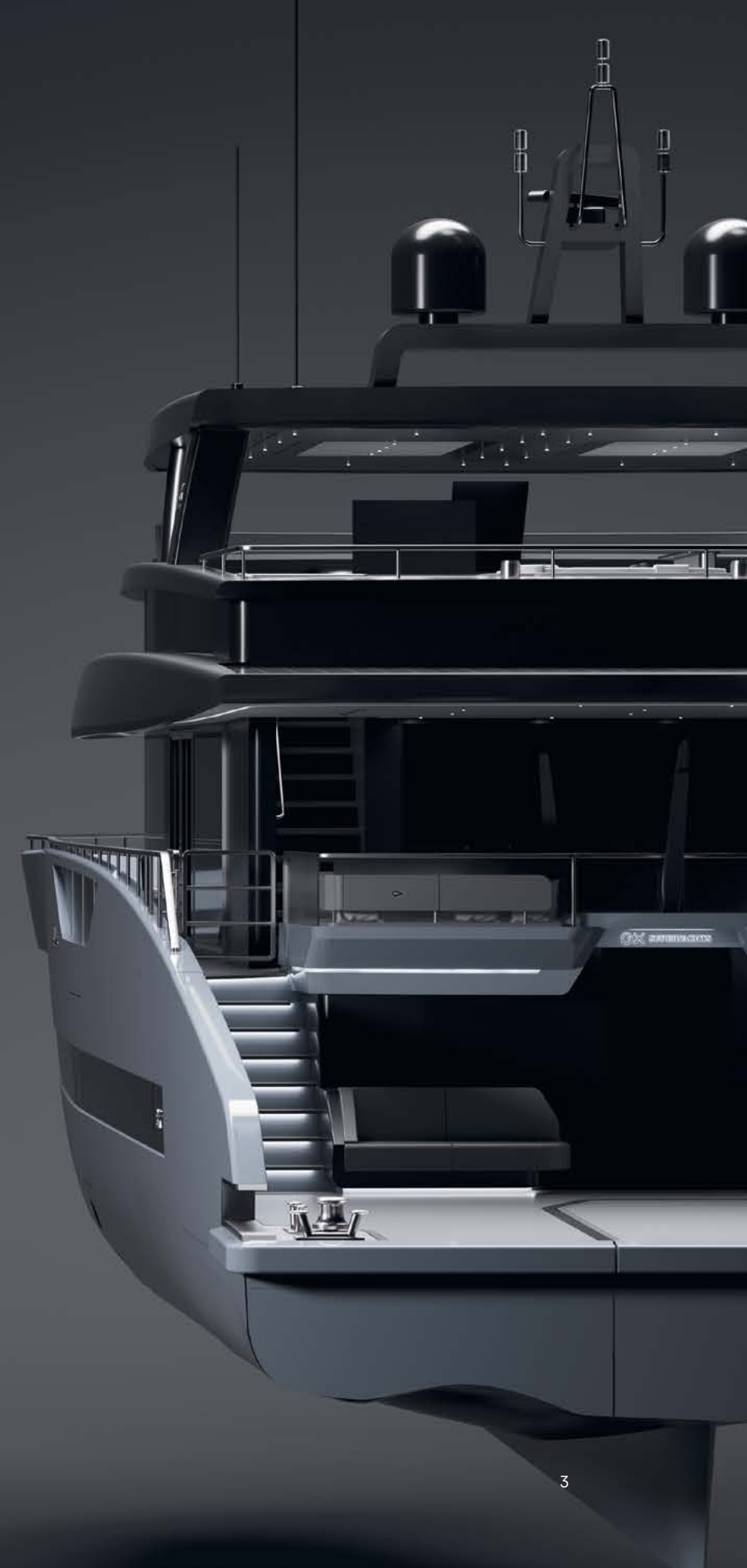

# Responsible Yachting

Superyachts, thoughtfully designed and crafted with the full life cycle in mind. Our focus extends beyond hybrid propulsion and integrated solar power - it's about embracing an entire concept. Our philosophy seamlessly merges cutting-edge innovation with a deep commitment to environmental responsibility.

From the careful selection of raw materials to advanced manufacturing techniques, we prioritize minimizing environmental impact. Designed with the future in mind, our yachts incorporate technologies that reduce emissions and energy consumption while ensuring the recyclability of key components.

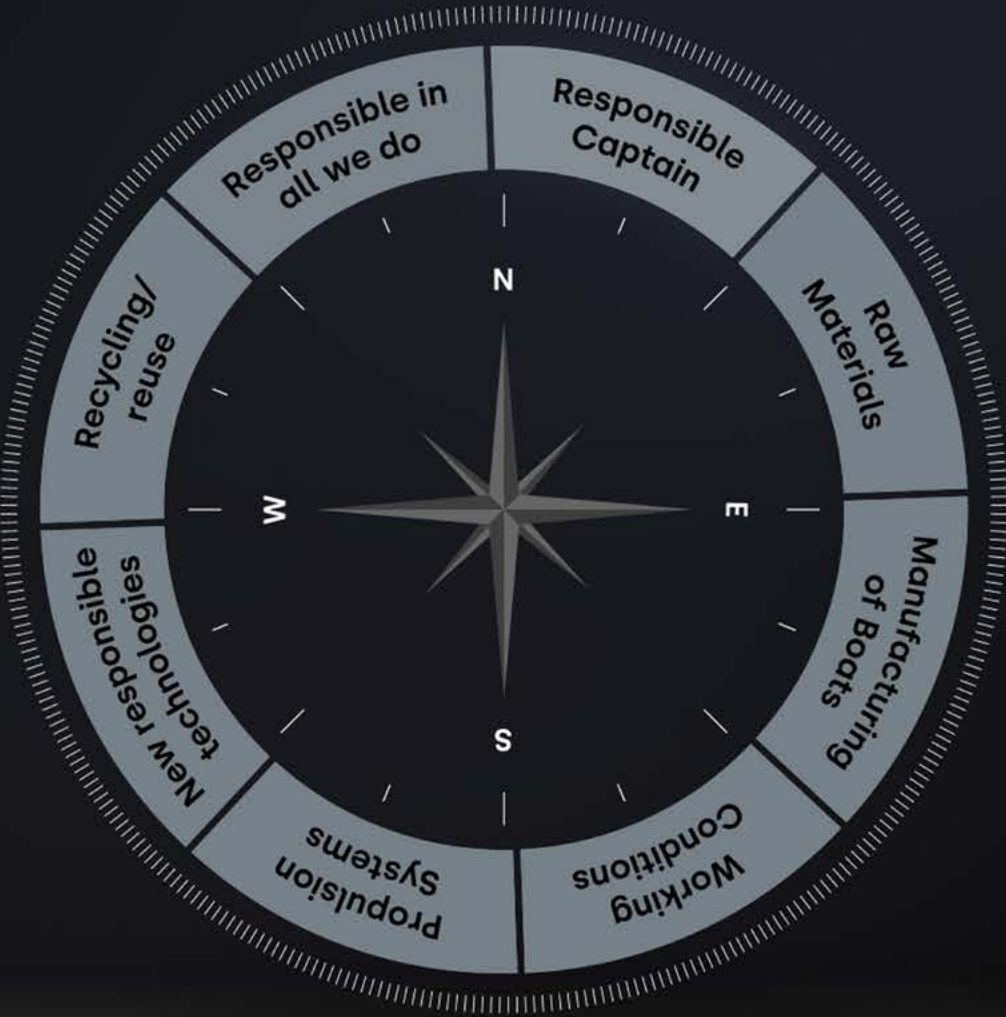



GX<sup>42</sup>

From the innovators of Greenline Yachts.



Our mission

**We constantly push the boundaries  
of what is technologically possible.**

Length	42.10 m
Beam	8.50 m
Draft	1.90 m
Speed	max 16 kts
Cruising Speed	12 kts

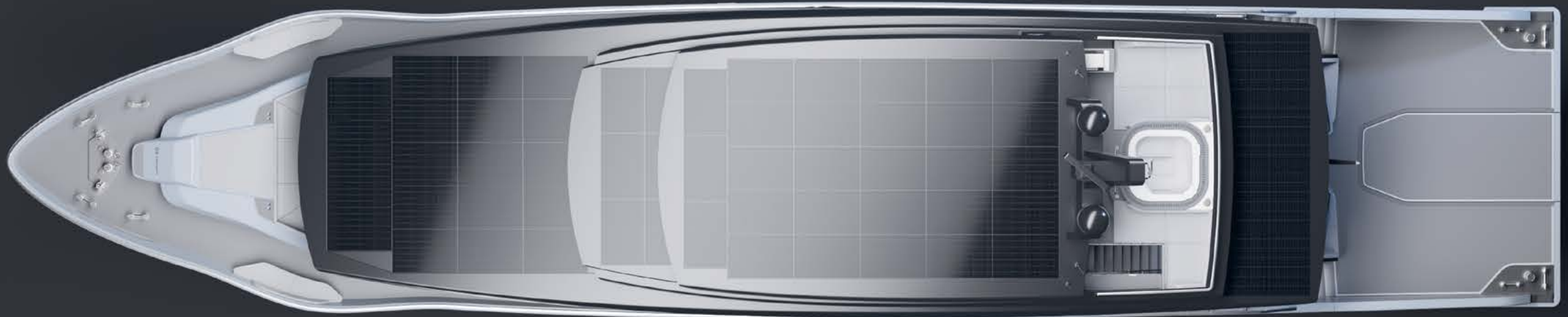





Design	Too Design, Marco Casali
Naval Architect	NAMES Studio, Francesco Rogantin
Builder	SES Yachts on behalf of GX Superyachts

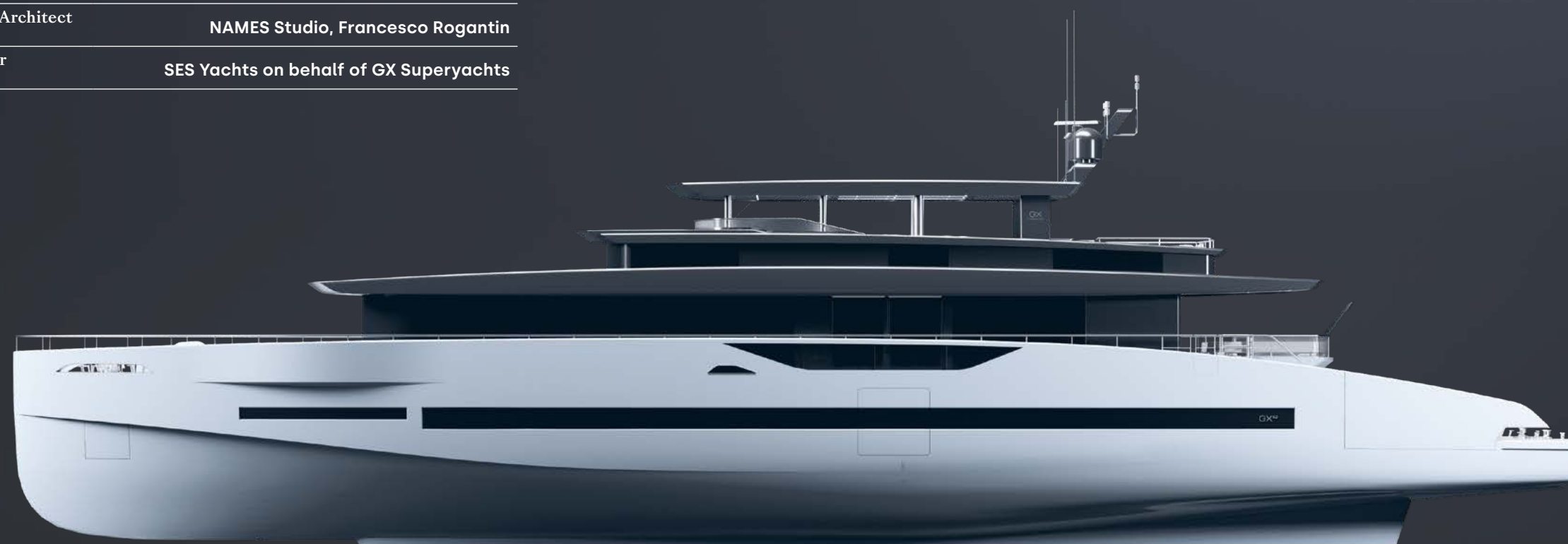



**GX 42 Coupe**

Gross Tonnage	335 GRT
Solar	up to 39 kW
Displacement	245t



**GX 42 RPH**

Gross Tonnage	353 GRT
Solar	up to 27 kW
Displacement	260t

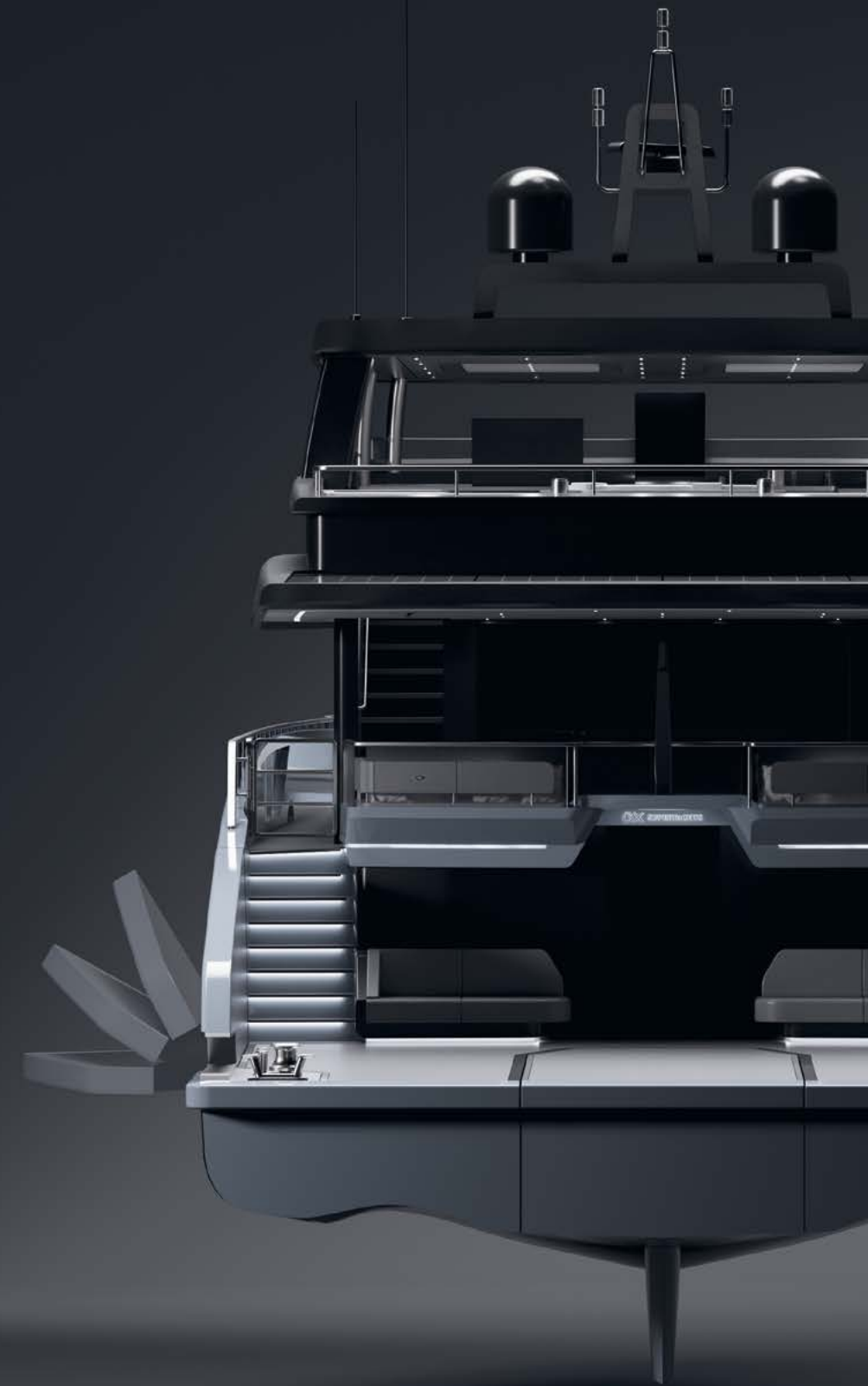
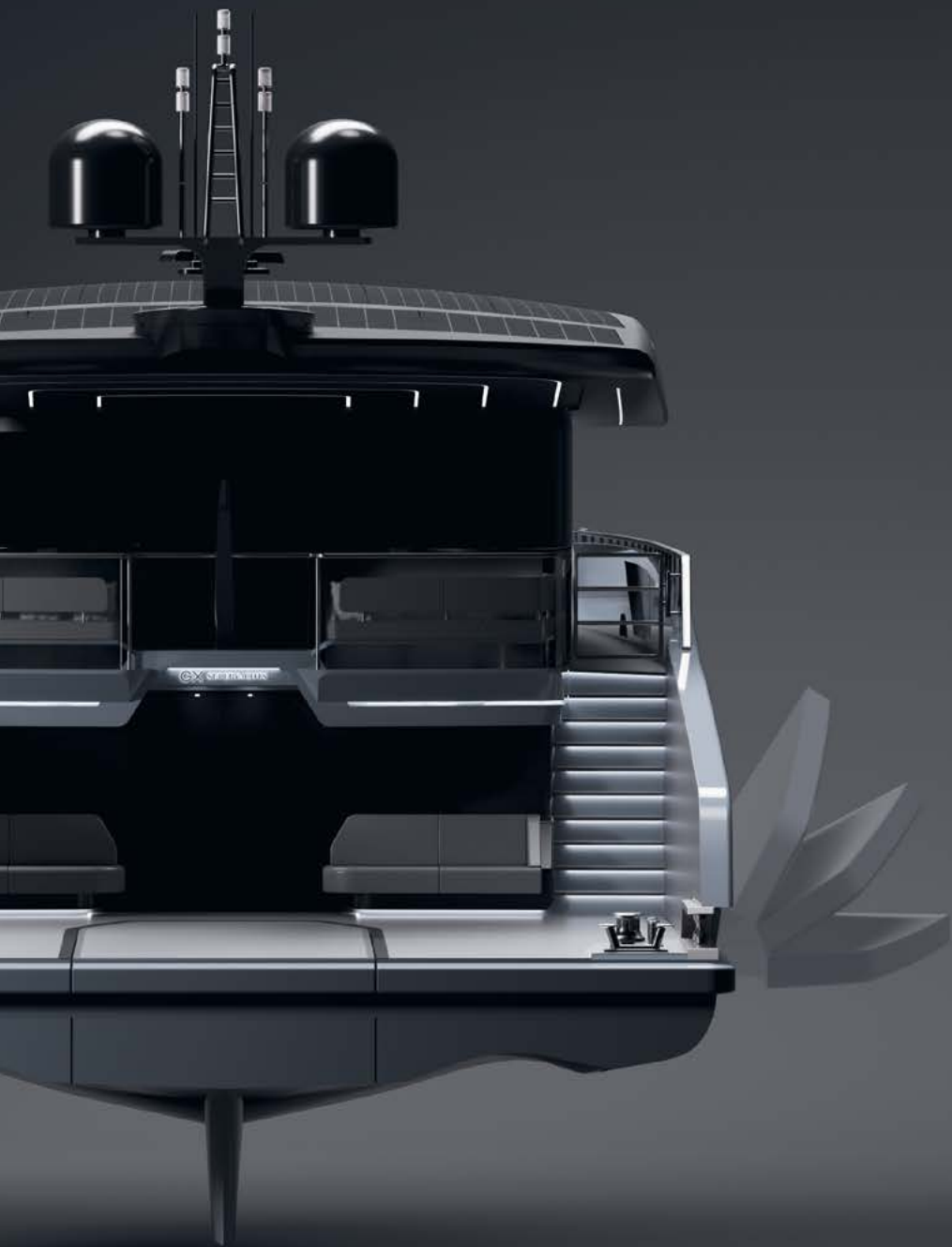



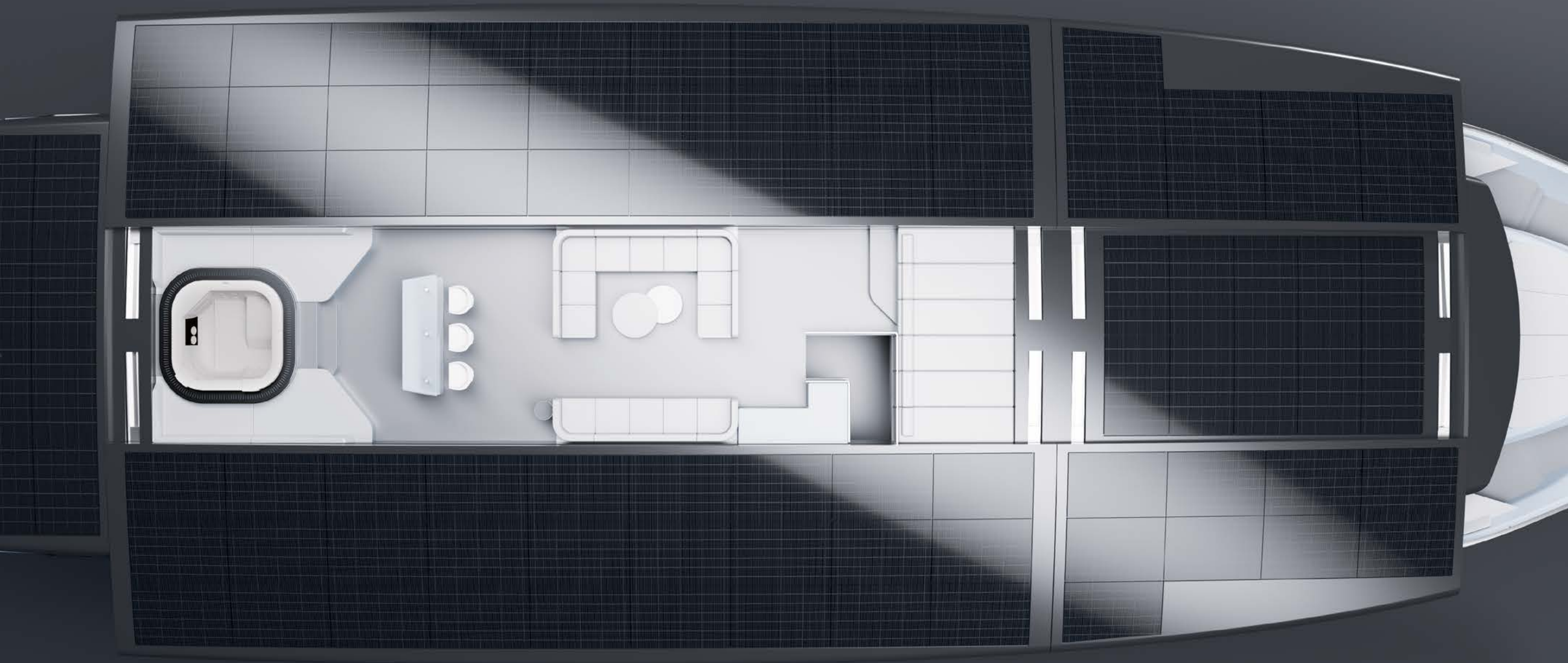



**GX<sup>42</sup> Coupe**

Roof panels

Sun Deck

Main Deck

Lower Deck

**Sun Deck**

- 01 Lounge Area
- 02 Bar
- 03 Whirlpool

**Main Deck**

- 01 Bridge
- 02 Captain's Office
- 03 Captain's Head
- 04 Captain's Cabin
- 05 Gallery
- 06 Foyer
- 07 Pantry
- 08 Dining Area
- 09 Lounge Area
- 10 Balcony

**Lower Deck**

- 01 Crew Head (3x)
- 02 Crew Cabin (3x)
- 03 Crew Mess
- 04 Guest Head (4x)
- 05 Guest Cabin (4x)
- 06 Owner Head
- 07 Owner Closet
- 08 Owner Cabin
- 09 Beach Club
- 10 Lazarette
- 11 Terrace

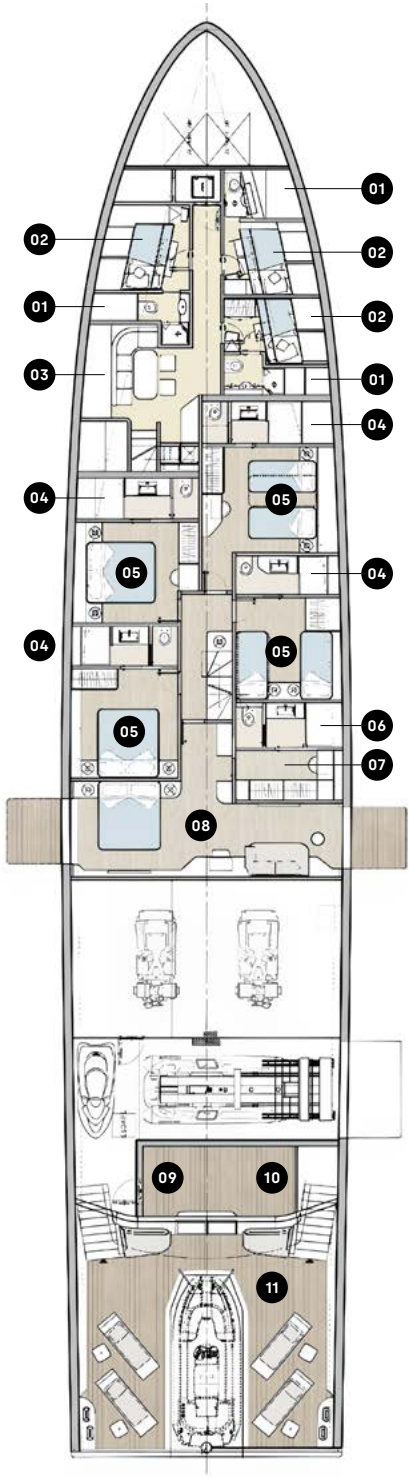
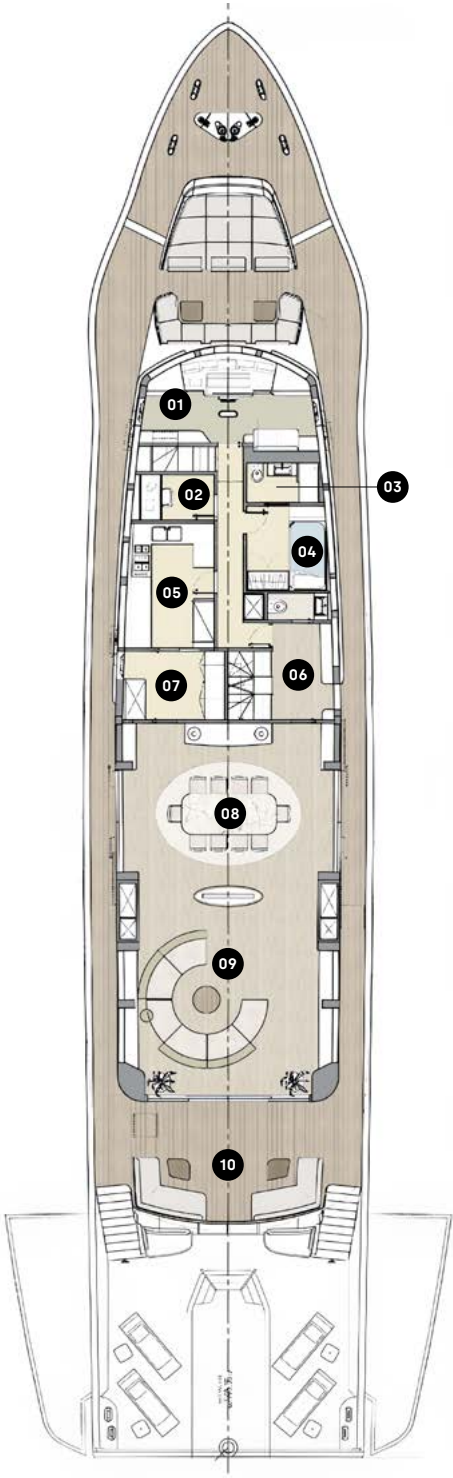
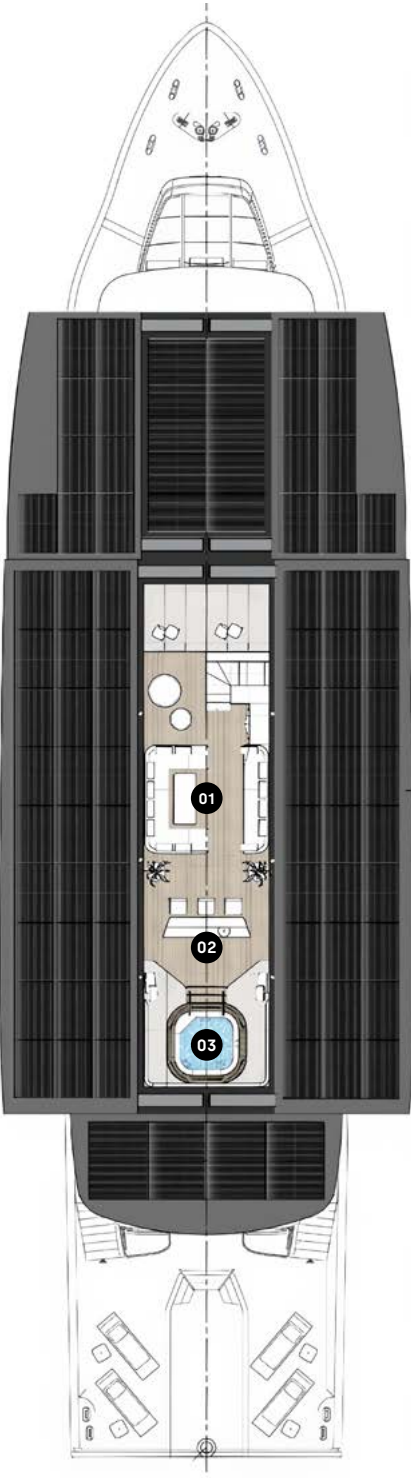



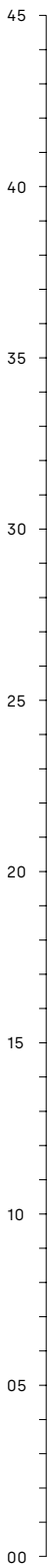

GX<sup>42</sup> RPH

Hard Top

Upper Deck

Main Deck RPH

Main Deck

Lower Deck



Upper Deck

- 01 Bridge
- 02 Dining Area
- 03 BBQ/Bar
- 04 Whirlpool (Delfi)

Main Deck

- 01 Owner's Cabin
- 02 Owner Head
- 03 Pantry
- 04 Foyer
- 05 Dining Area
- 06 Salon

Lower Deck

- 01 Crew Cabin (3x)
- 02 Crew Head (3x)
- 03 Captain's Cabin
- 04 Captain's Head
- 05 Crew Mess
- 06 Laundry
- 07 Gallery
- 08 Guest Head (3x)
- 09 Guest Cabin (3x)
- 10 VIP Cabin
- 11 VIP Wardrobe
- 12 VIP Cabin Head
- 13 Engine Room
- 14 Day Head
- 15 Beach Club
- 16 Lazarette

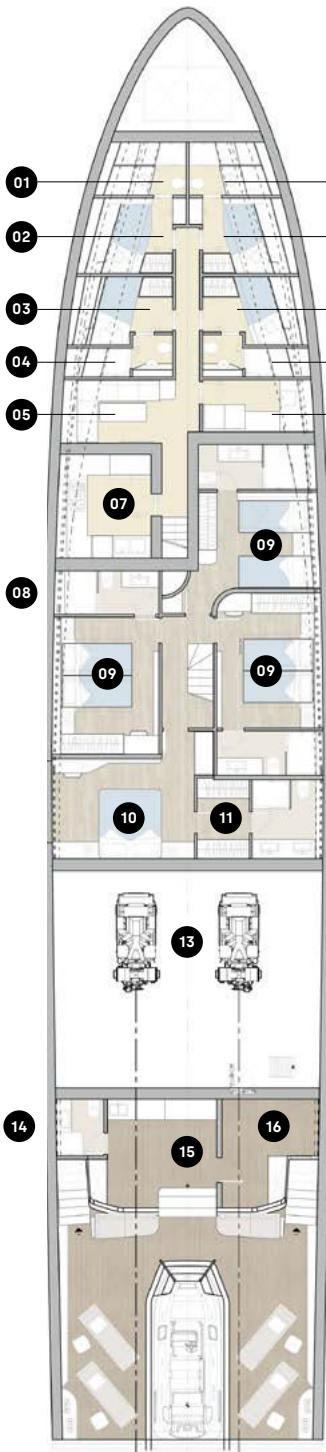
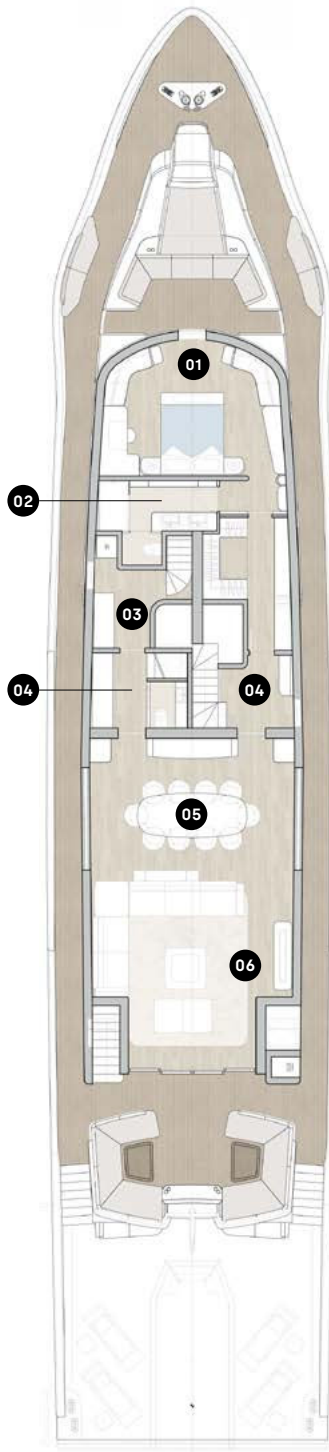
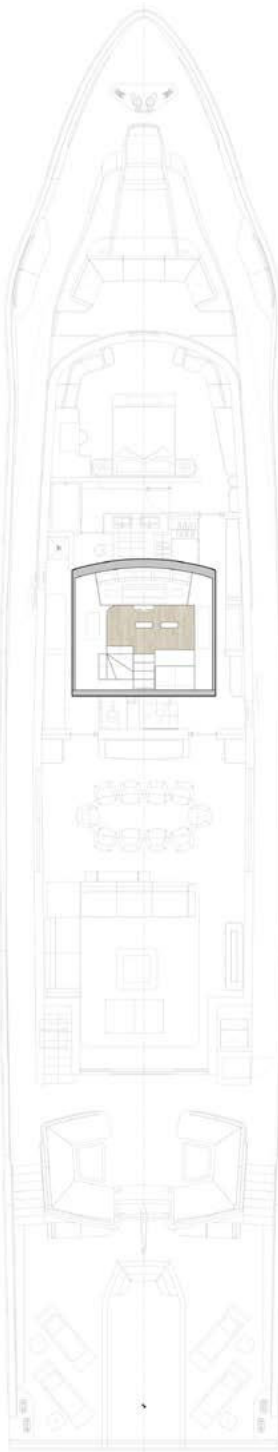
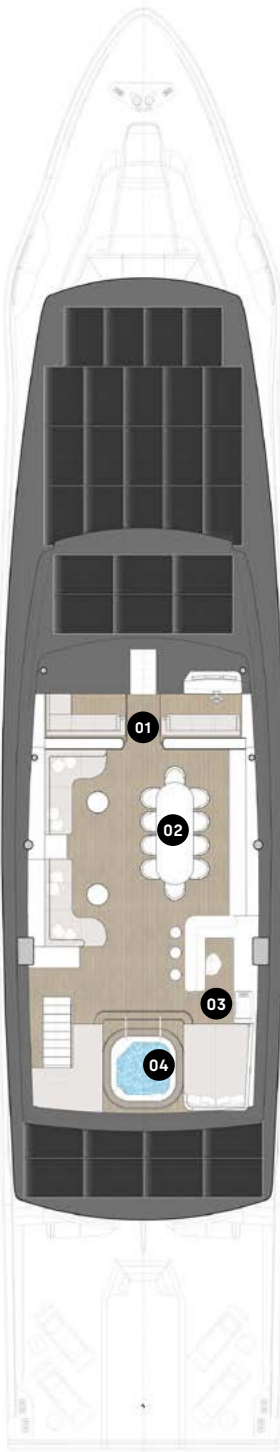
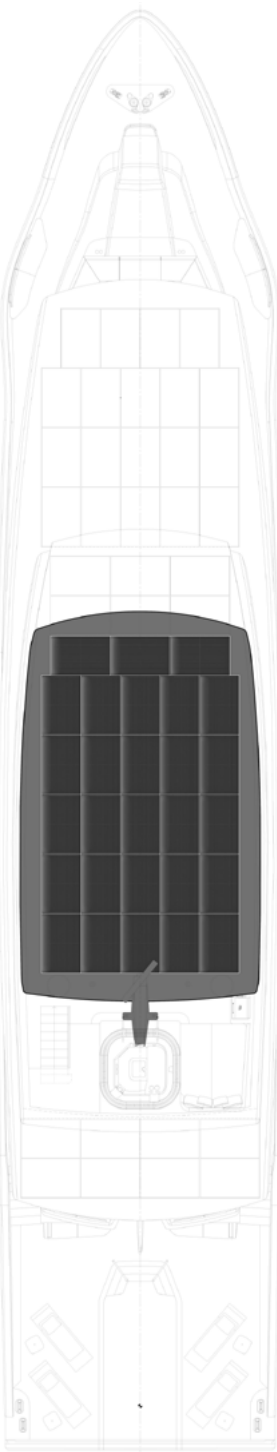



Our mission for the past sixteen years has been to push the boundaries of technological innovation. We are committed to delivering yachts that redefine efficiency and performance. That’s why our new superyacht features the most advanced hull design, optimized for long-range cruising and unparalleled performance in electric mode.



Hull data

Configuration	Monohull	Max beam on WL	7.85 m
Chine type	Round/multiple	Max molded draft	1.78 m
Length on WL	41.70 m	Displacement	220.00 t

Fuel consumption

Speed knots	Liters both Engines	Range in NM*	Load percentage
6 kts	14.00 l	11,571	3.3 %
8 kts	26.04 l	8,295	8.1 %
10 kts	54.00 l	5,000	17.0 %
12 kts	83.66 l	3,873	27.0 %
14 kts	159.80 l	2,365	51.1 %
16 kts	306.93 l	1,407	96.8 %

\*Total tank capacity: 30,000 - Range calculated with 10% tank reserve.

Disclaimer: All information contained here in, including technical and performance data, technical layouts, images, and graphic reproductions, is provided solely for informational purposes. All technical and/or descriptive information pertains only to the yacht's features as described in this brochure. Consequently, any binding information for which the seller is responsible will be provided exclusively in the yacht building contract and contractual technical specifications.



Speed predictions

Speed knots	kw both Engines	Avg. Hotel kW (considering solar)	Full Electric Range nm
5.00 kts	56	20	71
6.00 kts	80	20	60
7.00 kts	110	20	51
8.00 kts	150	20	43
9.00 kts	202	20	36
10.00 kts	274	20	29

Hull resistance curve

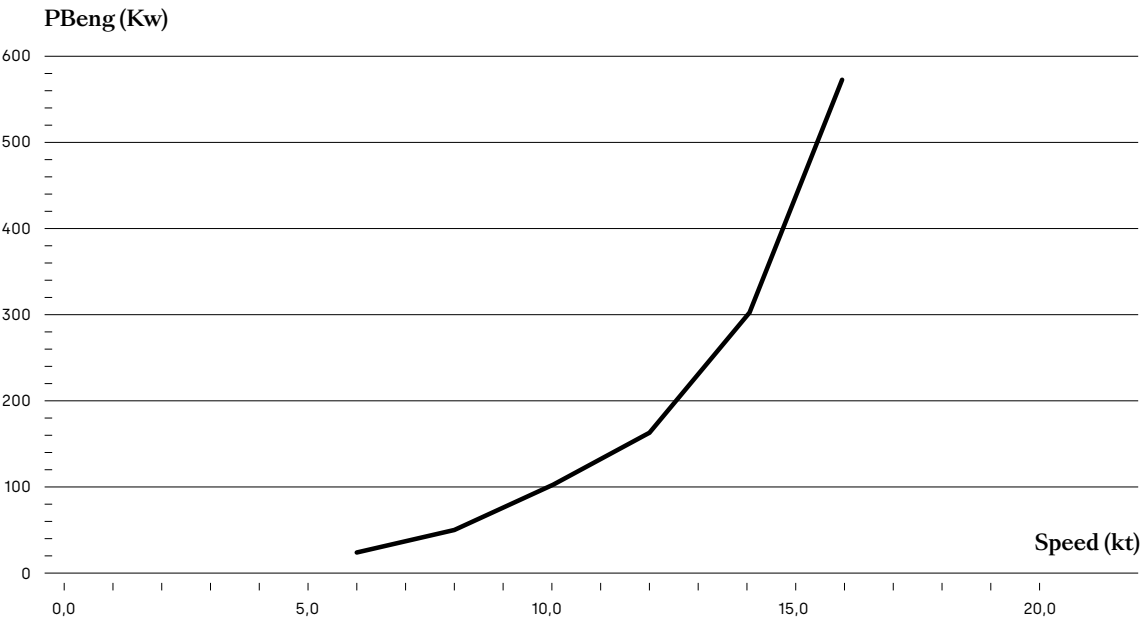

Disclaimer: All information contained here in, including technical and performance data, technical layouts, images, and graphic reproductions, is provided solely for informational purposes. All technical and/or descriptive information pertains only to the yacht's features as described in this brochure. Consequently, any binding information for which the seller is responsible will be provided exclusively in the yacht building contract and contractual technical specifications.



Average 42 meter Yacht vs GX<sup>42</sup> incl. Solar with Air Condition

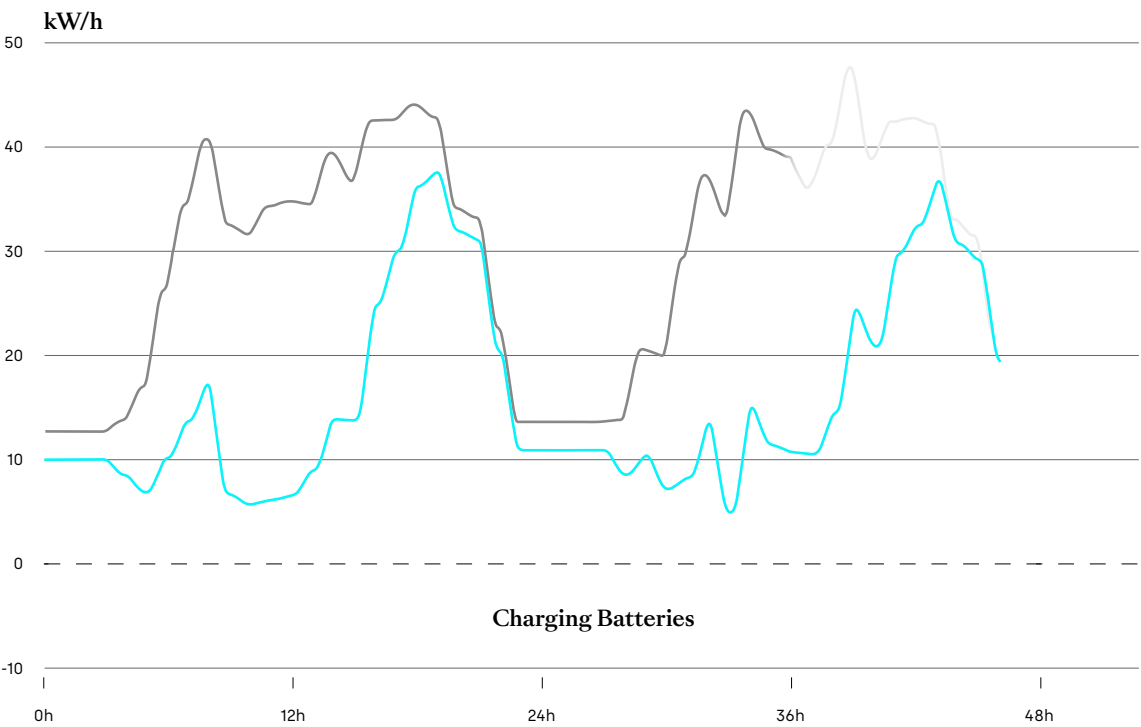

## 48-hour simulation showcasing the energy needs of battery & solar of a GX Superyacht at anchor.

Comparing an average 42 meter yacht with the same gross tonnage. The the GX<sup>42</sup> it is possible to anchor 48 hours in a simlated scenario without the need of fossile fules using 0.815 MWh of battery storage. 55% energy saving due to solar and optimised airconditioning system and other appliances.

Comparing the GX<sup>42</sup> with and without the use of airconditoning to simulatre a summer vs. spring scenario. More than 30% energy saving without airconditioning. Fresh air makers considered to be running below deck.

Disclaimer: All information contained here in, including technical and performance data, technical layouts, images, and graphic reproductions, is provided solely for informational purposes. All technical and/or descriptive information pertains only to the yacht's features as described in this brochure. Consequently, any binding information for which the seller is responsible will be provided exclusively in the yacht building contract and contractual technical specifications.

GX<sup>42</sup> incl. Solar with Air condition vs. GX<sup>42</sup> incl. Solar without Air Condition

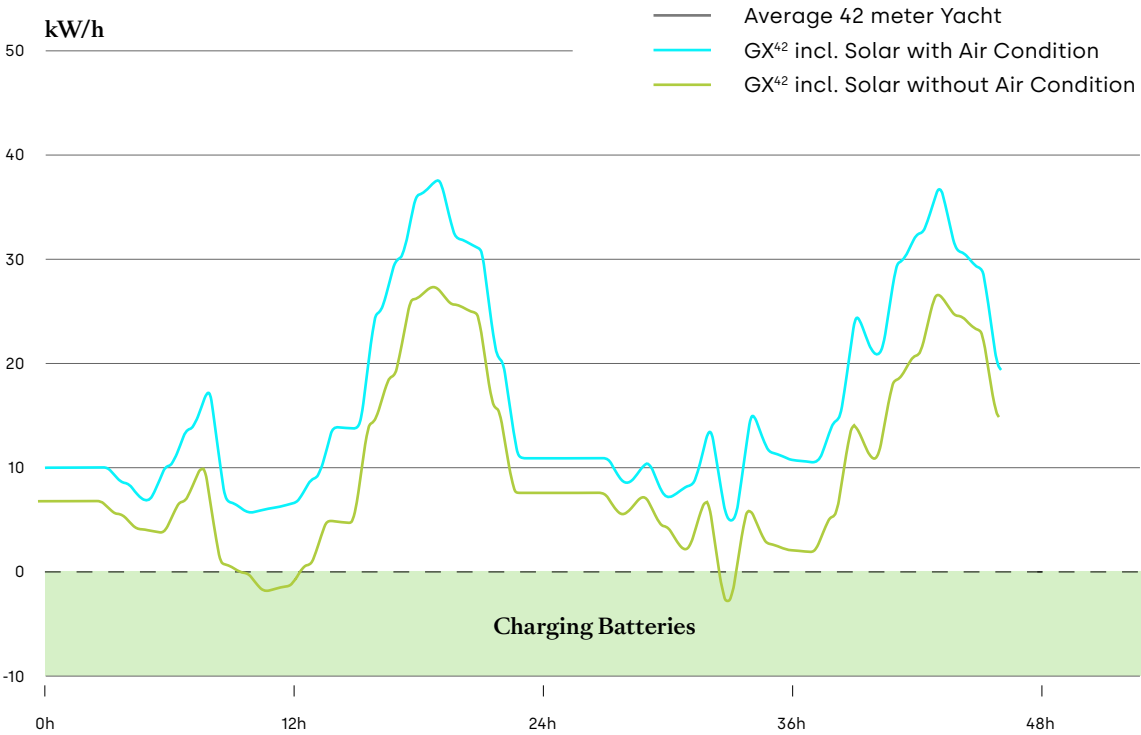

Consumption avg. 42 meter Yacht with Air condition

1493 kW/h

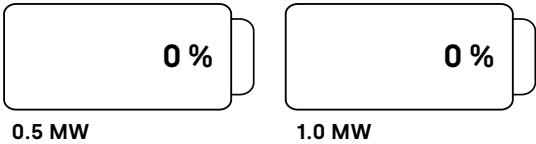

Consumption GX<sup>42</sup> incl. Solar with Air condition

815 kW/h

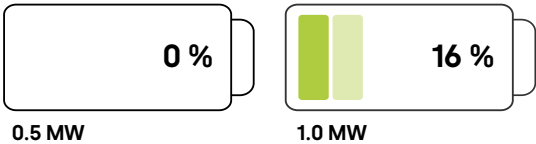

Consumption GX<sup>42</sup> incl. Solar without Air condition

552 kW/h

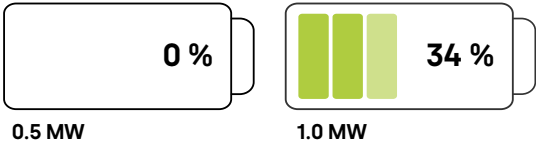



# The power of silence.

We believe that true comfort lies in silence. Our latest hybrid system, paired with cutting-edge battery technology and highly efficient solar panels, offers a range of options — from zero-emission cruising to zero-emission anchoring, and even a boost mode when you need extra speed. Explore all the details on our website.

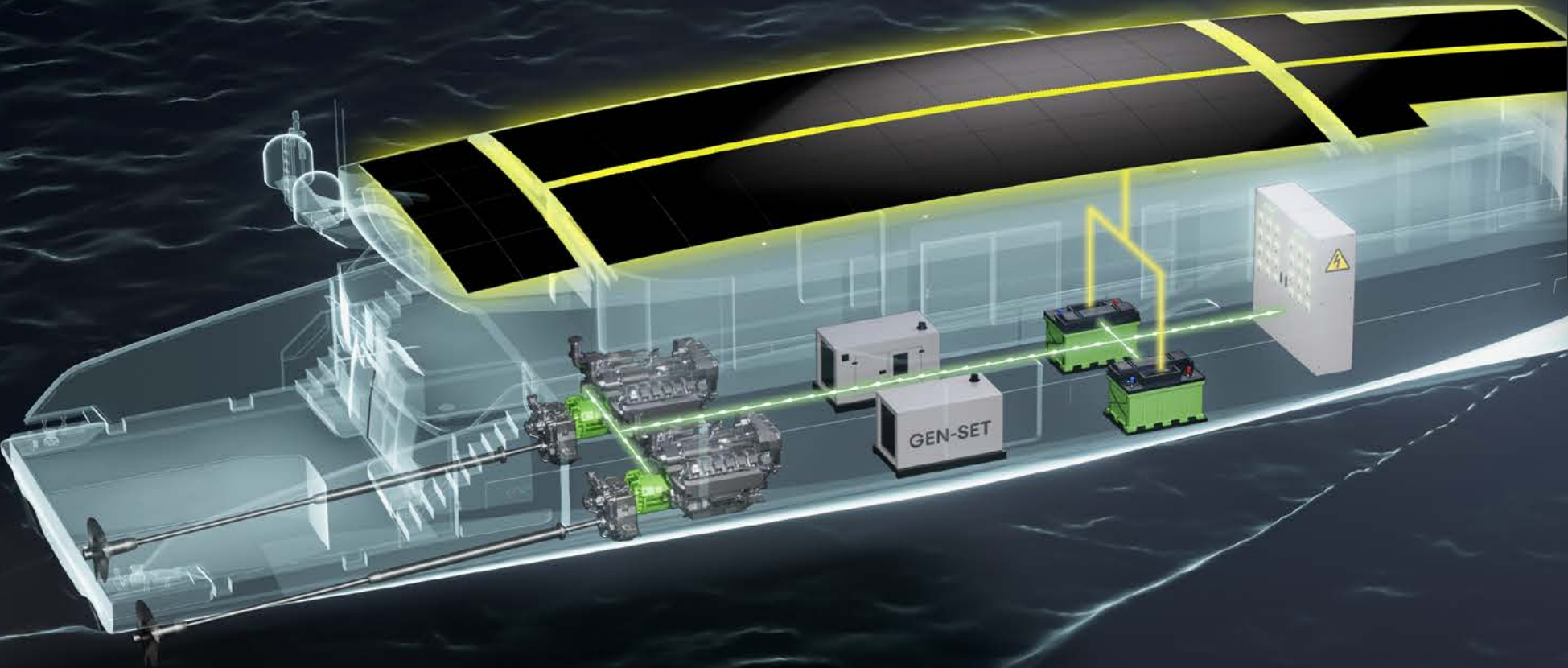

Exemplary Engine Mode:

## Zero-Emissions Navigation Mode



zero emissions



zero noise

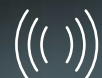

zero vibrations

All diesel engines are off. The batteries powers the electric motors for relaxed cruising and the hotel load simultaneously.



Detailed information about our innovative technology, engine modes and hull development of the GX Superyachts you find here: <https://gx-superyachts.com/fs-mb-2024>





Under development and ideas for the future

Design  
Too Design, Marco Casali



GX 56 Coupe



GX 34 Coupe

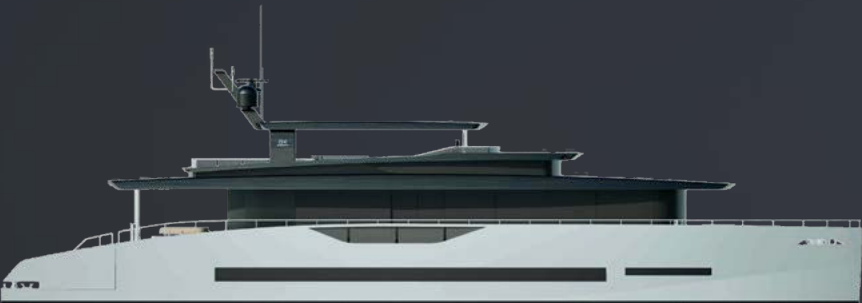

GX 34 RPH

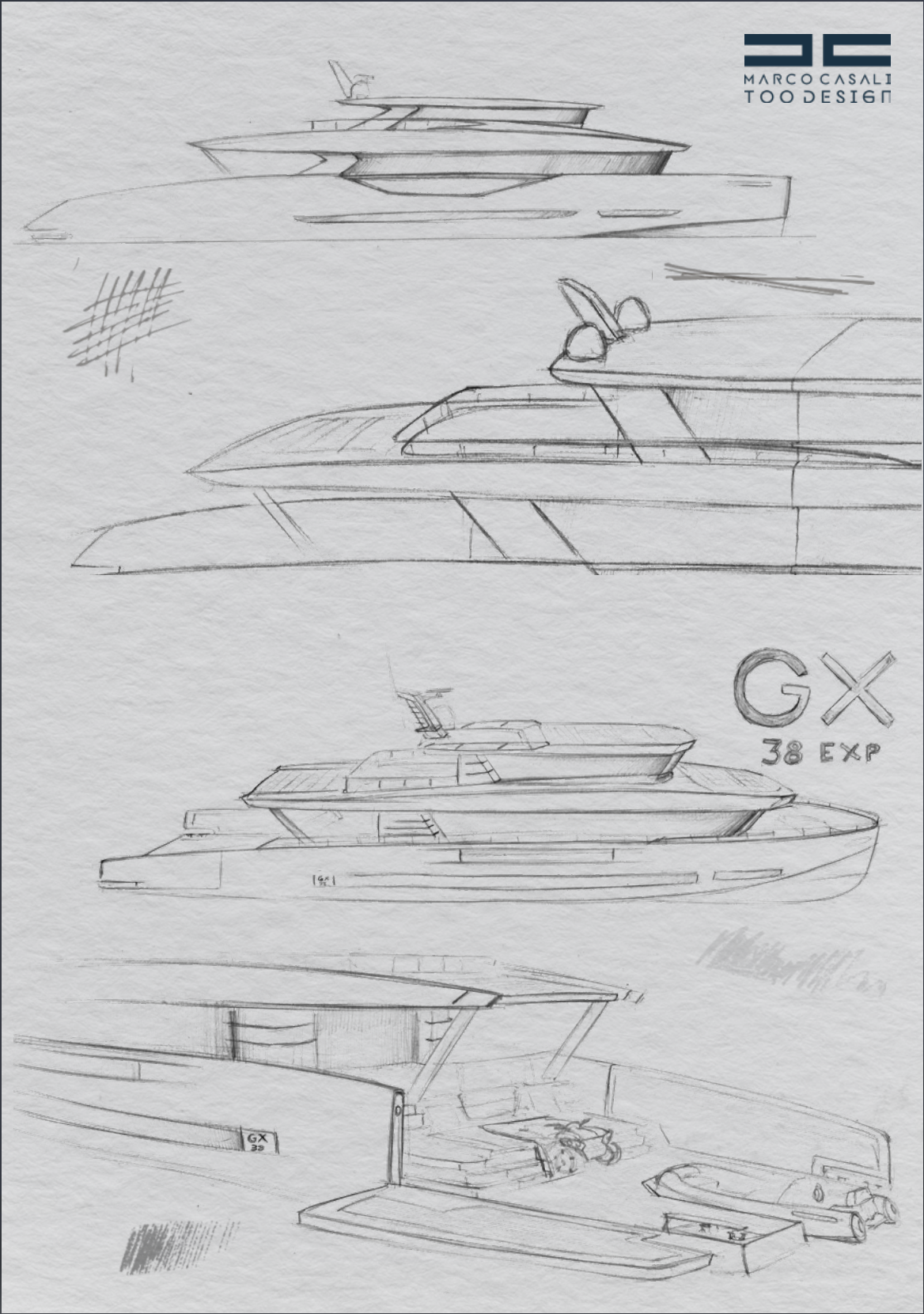

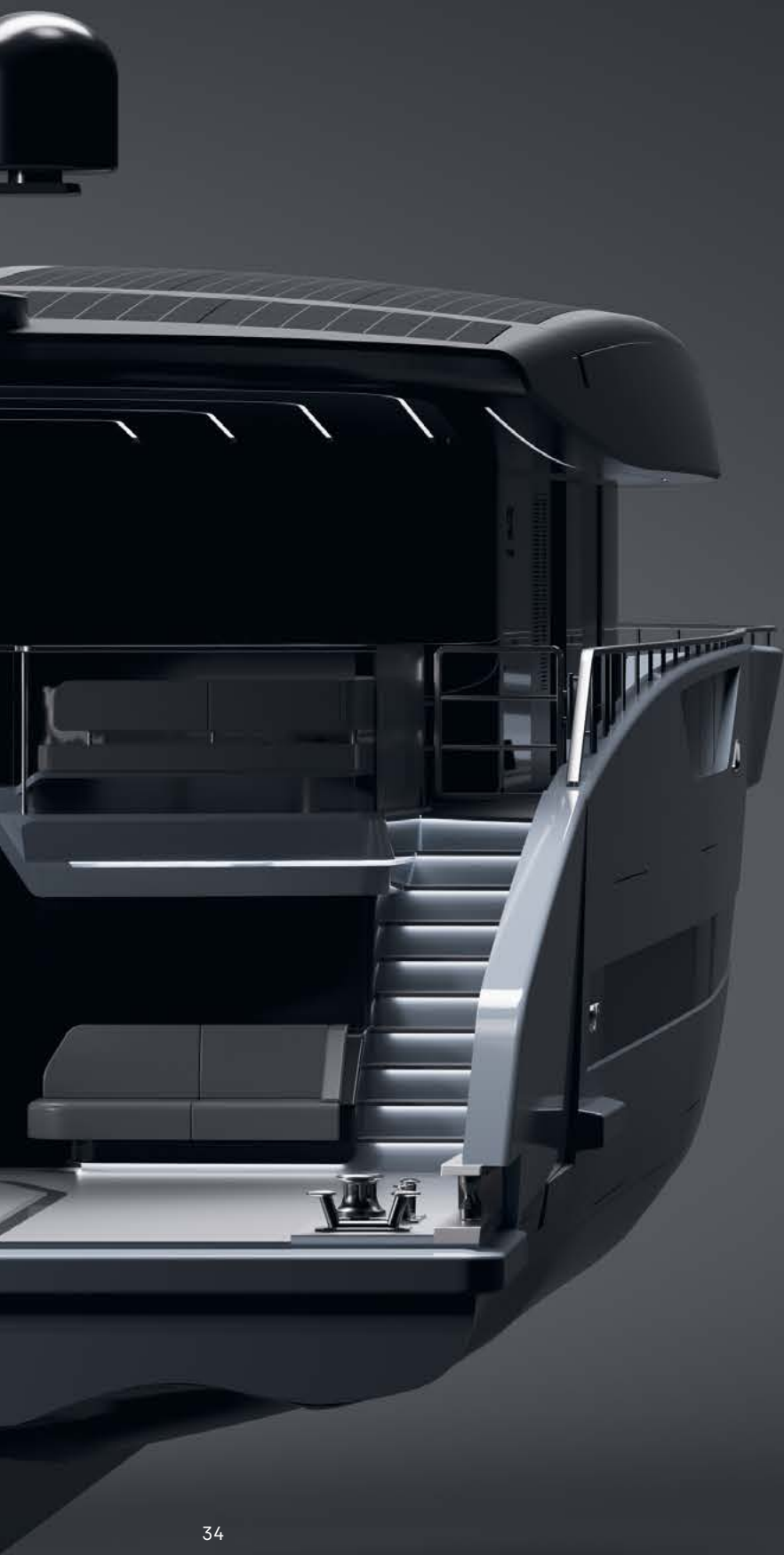

## Let us make your dream come true.

Our first 42-meter yacht is now under construction, serving as a preview of our future range, which will span from 30 to 60 meters. If you're ready to explore the next level of responsible yachting, our design and engineering team is here to create something truly special, tailored just for you. Contact us today to start turning your dream into reality.



For more information contact:  
[info@gxsuperyachts.com](mailto:info@gxsuperyachts.com),  
or fill out the form on our website.





GX-Superyachts d. o. o.  
Slovenia, Europe

[info@gx-superyachts.com](mailto:info@gx-superyachts.com)  
[gx-superyachts.com](http://gx-superyachts.com)



[gxsuperyachts](https://www.facebook.com/gxsuperyachts)



[GX Superyachts](https://www.linkedin.com/company/gx-superyachts)